

Welcome to TOYOHASHI

HONOKUNI DEPARTMENT STORE Access Information

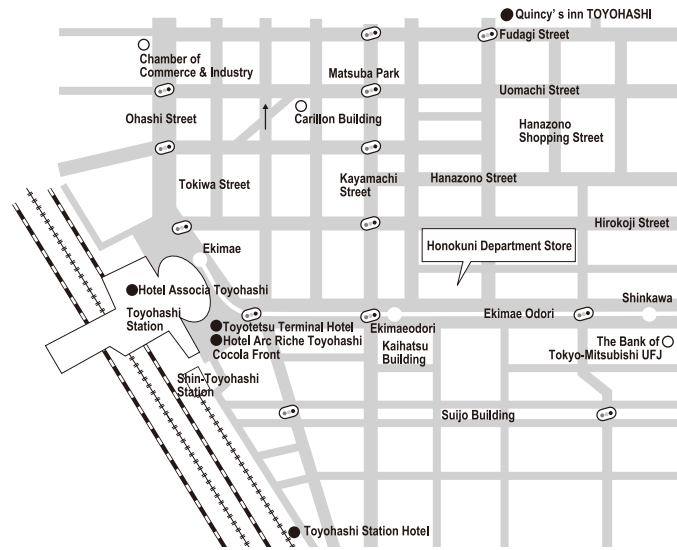

■ Business hours 10:00~18:30
2-10 Ekimae-odori Toyohashi AICHI 440-0888
PHONE:0532-54-1211

■ 营业时间 10:00~18:30
邮编440-0888 爱知县丰桥市駅前大通2丁目10番地
电话:0532-54-1211

■ 영업 시간 10:00~18:30
우편번호440-0888 아이치현 도요하시시 에키마에오도리 2가 10번지
전화:0532-54-1211

■ 營業時間のお知らせ 10:00~18:30
〒440-0888 豊橋市駅前大通2-10
TEL.0532(54)1211(代表)



http://honokuni-dept.jp/

2015.10

Notice on the Consumption Tax Refund

General Articles

The consumption tax is refunded if the total purchase in a given day is ¥10,001 (tax exclusive) or more.

Consumables

*Food products, beverages, liquor, pharmaceutical products, cosmetic products and other consumables.

The consumption tax is refunded if the total purchase in a given day is ¥ 5,001 or more and up to ¥ 500,000(tax exclusive).

*Articles purchased by non-residents clearly for business or for resale purposes are excluded from tax refund.

1. When you do your shopping, please pay the consumption tax.
2. After your shopping, please bring all the articles you purchased and the receipts of your payment to the tax refund counter on the sixth floor.

消費税免除通知

一般商品

一日内购物总额达 10001 日元以上 (不含税) 时可免除消费税

消耗性商品

*食品类, 饮料类, 酒类, 药品类, 化妆品类及其他消耗性商品

一日内购物总额达 5001 日元以上 50 万日元以内 (不含税) 时可免除消费税

*非定居者购入的商品, 若明显为用于企业或销售用途的, 将不属于免税对象

1. 购物时, 请支付消费税。
2. 购物后, 请带着您购买的所有物品及付款收据至六楼的免税柜台

소비세 면세의 알림

일반물품

하루 구입 금액 합계가 10,001엔 이상(세금 별도)이면 소비세가 면제됩니다.

소모품

*식품류, 음료류, 주류, 약품류, 화장품류, 기타 소모품 하루 구입 금액

합계가 5,001엔 이상 50만 엔(세금 별도)이하이면 소비세가 면제됩니다.

*비거주자가 사업 또는 판매용으로 구입한 것이 분명한 물품은 면세 판매 대상에서 제외.

1. 쇼핑을 하실 때는 소비세를 납부하여 주십시오.
2. 쇼핑을 하신 후, 구입제품 및 지불하신 영수증을 모두6층의 면세카운터로 가지고 오십시오.

消費税の免税について

一般物品

1日のお買い上げ金額合計10,001円以上(税別)で消費税が免税されます。

消耗品

*食品類、飲料類、酒類、薬品類、化粧品類、その他の消耗品

1日のお買い上げ金額合計5,001円以上50万円まで(税別)で消費税が免除されます。





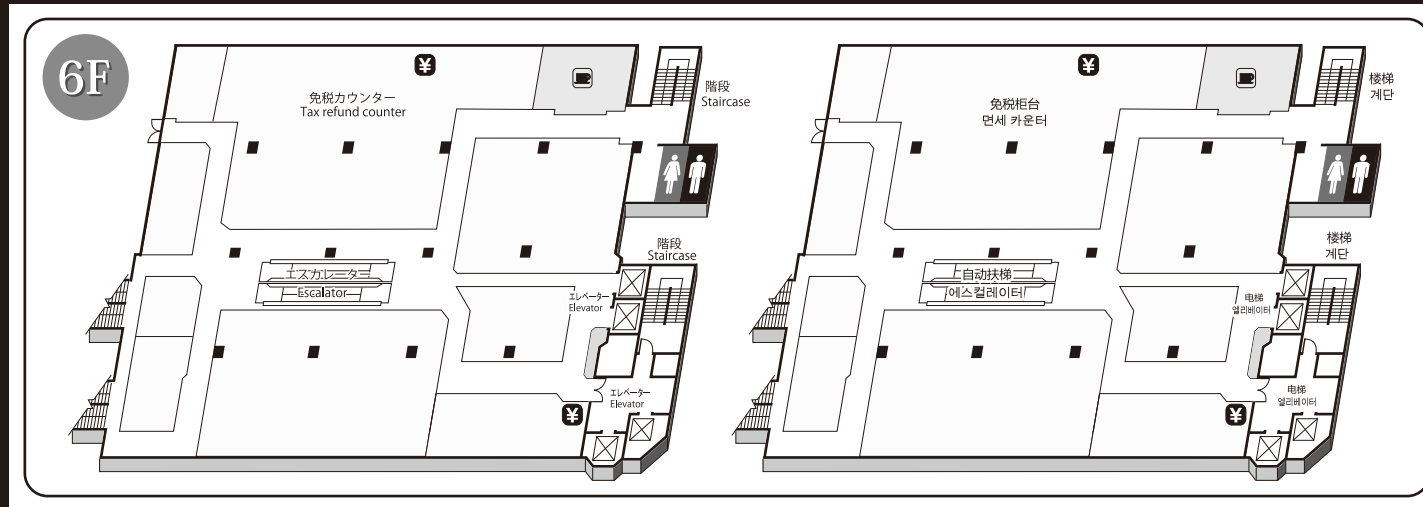

*非居住者が事業または販売用として購入することが明らかな場合は免税販売対象外となります。

1. お買い物の際は消費税をお支払いください。
2. お買い物の後、購入した商品及びお支払いの領収書を6階免税カウンターへお持ちください。



HONOKUNI Department store

10F	Large Customer Department (Office)	  
9F	Restaurants, Event Space	 
8F	Baby and Children's Fashion, Exhibition Hall ●Baby and Children's Wear ●Baby and Maternity Goods ●Baby Care Lounge ●Exhibition Hall	
7F	Jewelry, Kimono, Art Gallery ●Jewelry ●Watches & Clocks ●Kimono ●Interior Goods ●Home Appliances ●Art Gallery	
6F	Household Goods, Card Information Service, Gift Certificates ●Tableware ●Household Goods ●Bedding ●Bath Articles ●Interior Goods Tax refund counter Café TEA TIME	 
5F	Men's Fashion	
4F	Ladies' Fashion (Missy & Mrs. / S & L-Size)	 
3F	Ladies' Fashion (Prêt-a-Porter & Career)	 
2F	Ladies' Fashion (Young & Young-Career) Café VOYAGE	 
1F	Cosmetic, Ladies' Shoes, Sundries ●Information Counter ●Cosmetic World ●Bags ●Ladies' Shoes ●Ladies' Accessories ●Variety Goods ●Jewelry	
B1F	Foods ●An arcade of well-known stores	
B2F	Underground Parking Area	

-  Restrooms
-  Restrooms for Women
-  Family Restrooms
-  Powder Room
-  Coffee Shop
-  Telephone
-  Restroom for Wheelchair Users

外销部

9楼

8楼

·婴儿、儿童服装 ·新生儿用品、孕妇用品
·婴儿休息室 ·展览厅

·宝石 ·手表和时钟 ·和服 ·室内装饰用品
·家电 ·美术陈列室

·餐具 ·家庭用品 ·床
·浴室、卫生间用品 ·室内装饰

2楼

1楼

·店内案内所 ·名牌化妆品专柜 ·皮包
·女用鞋 ·女士用品 ·杂货 ·饰品

地下1楼

·味の名店街

地下2楼

-  洗手间
-  洗手间 (女士用)
-  洗手间 (儿童和同伴者洗手间)
-  化妆间
-  咖啡店
-  公用电话
-  轮椅者用洗手间



免税柜台 咖啡店 TEA TIME



咖啡店 VOYAGE



외판부

·유아 ·아동복 ·신생아용품 임산부용품
·유아휴게실 ·전시장

·보석 ·시계 ·기모노(정장 캐주얼) ·인테리어 용품
·가전 ·화랑

·식기 ·가정용품 ·침구
·욕실 화장실 용품 ·인테리어 **면세 카운터** **찾집 티타임**

·점포 안내소 ·코스메틱 월드
·가방 ·여성패션 ·여성용품 ·잡화
·액세서리

·맛의 유명 상점가

- 화장실
- 화장실 (여성용)
- 화장실 (어린이와 동반자용 화장실)
- 파우더룸
- 커피숍
- 공중전화
- 휠체어용 화장실

外商部

●ベビー・子供服 ●新生児用品・マタニティ用品
●ベビー休憩室 ●催事場

●宝石 ●時計 ●呉服 ●インテリア用品
●家電 ●美術画廊

●食器 ●家庭用品 ●寝具
●バス・トイレ用品 ●インテリア **免税カウンター** **喫茶** **ティータイム**

●店内案内所 ●コスメティックワールド
●バッグ ●婦人靴 ●婦人用品 ●雑貨
●アクセサリー

●味の名店街

- お手洗い
- お手洗い (女性用)
- お手洗い (親子トイレ)
- パウダー ルーム
- 喫茶
- 公衆電話
- 車いす用お手洗い

찾집 보아지

喫茶 ボヤージュ

